

# Tatum

Est. 1912

VENUE  
ACCOMMODATION

Work, Rest, and Play

Where Historic Charm Meets Modern  
Excellence – Host Your Next Event at  
Tatum, Wellington's Premier  
Conference Destination





# *Tatum*

Est. 1912

- Venue descriptions
- Accommodation
- Dining
- FAQs

# Pavillion

- Features Capacity: Up to 160 guests
- Venue Highlights: Purpose-built event space with a wraparound veranda, festoon-lit outdoor areas, and seamless indoor-outdoor flow
- Amenities:
  - Full bar and commercial kitchen
  - Flexible furniture and event styling options
  - 95" Smart TV, wireless microphone, and surround AV sound
  - Outdoor heating around the veranda
  - Air conditioning and fresh air system
  - Natural light or blackout event lighting
- Accessibility: Wheelchair accessible, ground level
- AV Support: AV specialist recommended for larger events
- Outdoor Access: Direct access to outdoor spaces





# Cobham

- Capacity: 60-80 guests
- Warm, professional, and filled with natural light, The Cobham Room offers panoramic views of the Tararua Ranges and opens onto a large private furnished deck for fresh air and breakout sessions.
- Smart TV, integrated AV, microphones, and whiteboard
- High-speed Wi-Fi, air conditioning
- Private deck with mountain views
- Full bar service available
- Access by stairs to second floor

# The Lookout

- Capacity: Up to 15 guests
- A “chapel-like” structure nestle among the tree. The Lookout offers tranquility and inspiration with a cascading deck and botanical mural.
- Full AV, including exterior speakers
- Event lighting with sunset glow
- Air conditioning, disability access
- Indoor/outdoor flow with deck
- Perfect for dining , creative sessions , board meetings or nature-inspired events



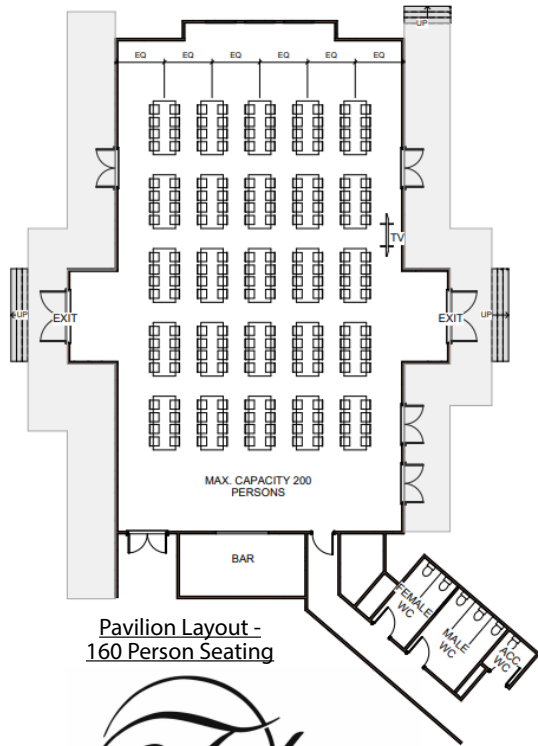

Pavilion Layout -  
160 Person Seating

*Tatum*  
Est. 1912

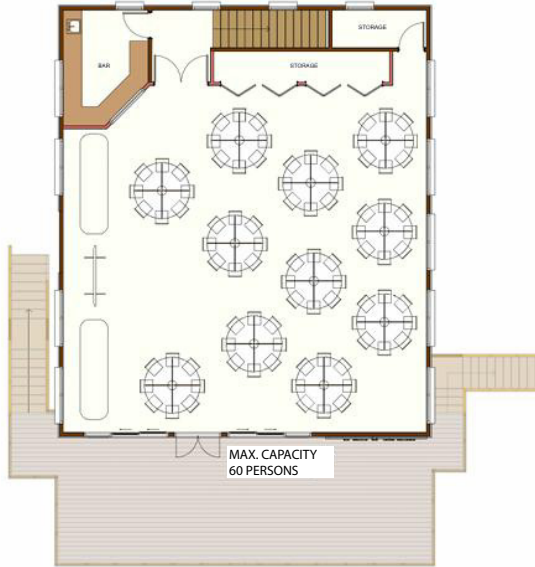

Cobham Conference Room - Banquet Layout

*Tatum*  
Est. 1912

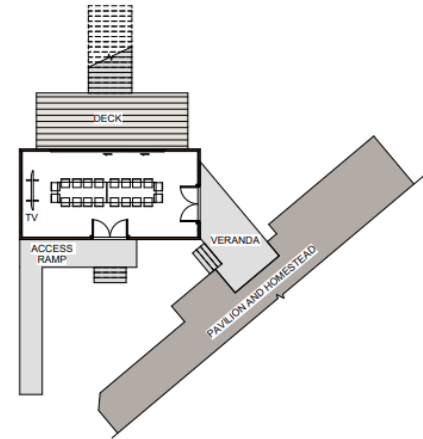

Lookout Room Layout - 15 Person Seating

*Tatum*  
Est. 1912

# Conference Venue Floor Plans

# Cooksley Corner –

- Rustic, starlit space
- Festoon lighting, dance area
- Outdoor Full bar and BBQ/pizza trailer available



# Tatum House Lawn

- Alfresco dining, games, or evening gatherings
- Large deck, festoon lighting, limestone walkways
- Adjacent to Pavilion and bar
- Outdoor speakers
- Lounge furniture
- Outdoor bar set ups and outdoor keg bar



# Accommodation at Tatum





## Modern Boutique Suites

- 29 designer suites (sleep 2–3 per suite; up to 64 guests)
- Super-king or twin beds, plush linens
- Chic ensuite bathrooms
- Kitchenette
- Smart TV, Wi-Fi, air conditioning
- Outdoor seating
- Family, accessible, and pet-friendly options

# Tatum House Luxury Suite

- 1 exclusive suite (sleeps 2)
- Grand king bed, opulent bathroom (soaking tub, rain shower)
- Elegant lounge, 2x smart TVs
- French doors to dual balconies with garden views



# Conference Menus

- Energizing breakfasts: pastries, fruit.
- Working lunches: grazing platters and woodfire pizza.
- 2-3 course meals available in buffet or family style.  
Minimum 30 pax
- Full bar available.

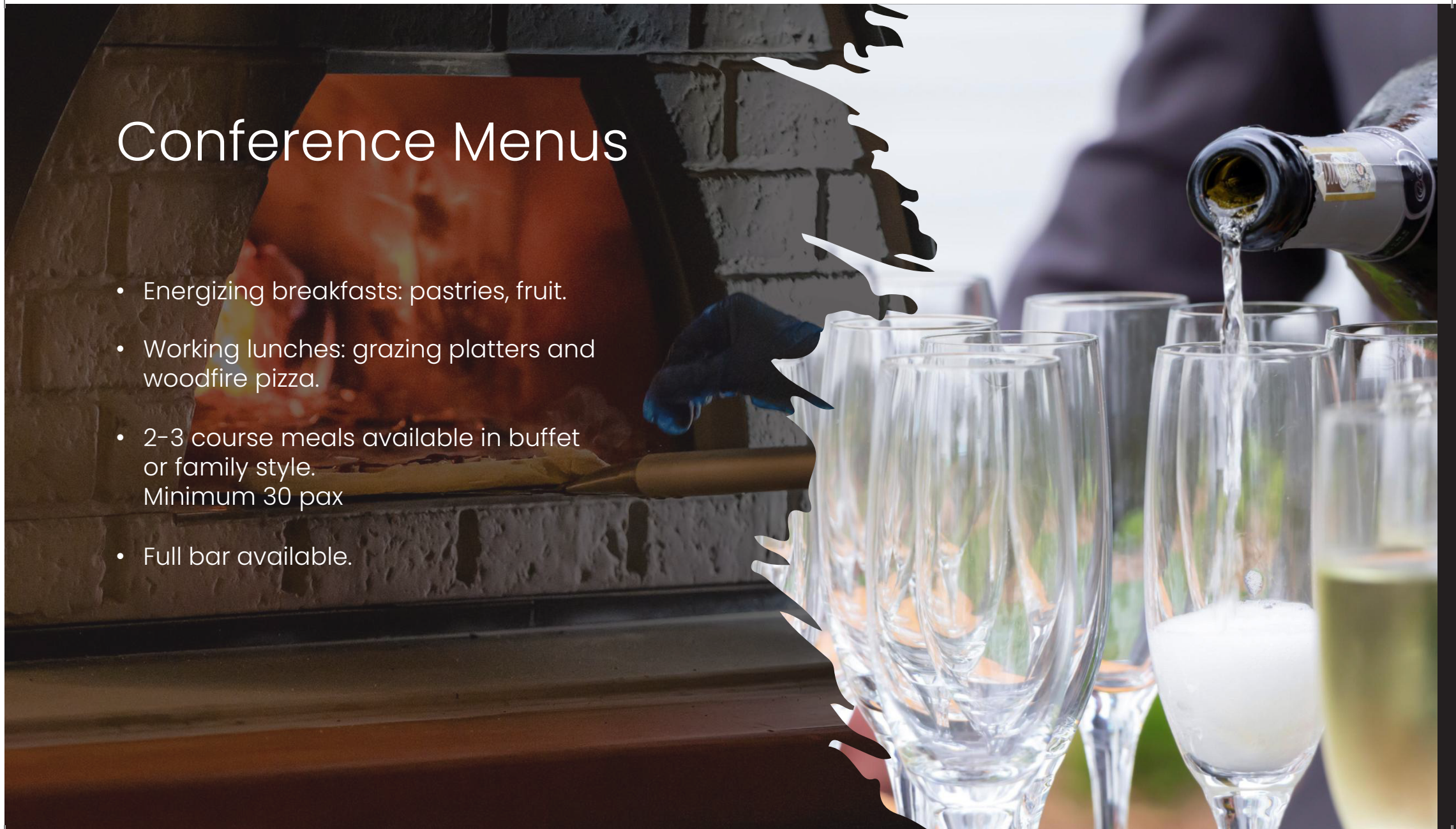

# Unique Touch

From elegant alfresco feasts under the stars to chef-tailored menus crafted just for your group, Tatum makes every meal memorable.

And with our mobile pizza trailer, you can enjoy gourmet wood-fired pizzas at any spot — onsite.



# FAQs & Booking Information



## How to Book:

- Visit [www.tatum.co.nz](http://www.tatum.co.nz)  
[hello@tatum.co.nz](mailto:hello@tatum.co.nz)

## Can I get a quote or tour?

- Yes! We offer obligation-free quotes and welcome you for a walk-through or familiarization visit.

## What's included in my booking?

- Exclusive or shared use of event spaces
- Onsite accommodation options
- Tailored menus and beverage packages
- Full event planning support
- Tea and coffee self service station
- Event stylist available
- Basic AV with Smart TV monitor and wireless microphone
- Please note for large events we recommend a professional AV partner.

## Is Tatum accessible and pet-friendly?

- Yes! Accessible rooms, family-friendly facilities, and pet-friendly units available.

## Where is Tatum located?

- 850 State Highway 1, Levin, Horowhenua.





*Tatum*  
Est. 1912

[hello@tatum.co.nz](mailto:hello@tatum.co.nz)